

OVERALL

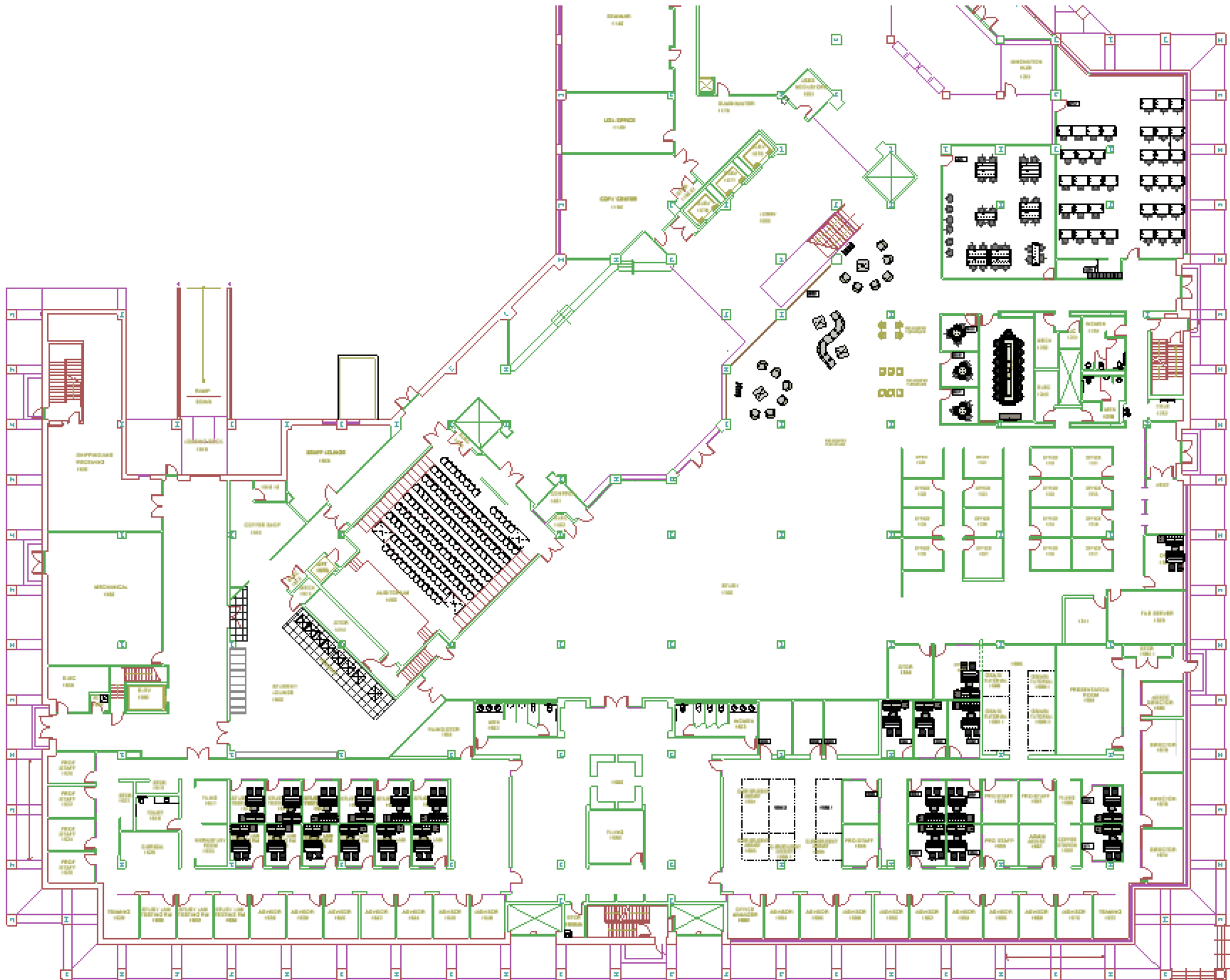

PRIVATE OFFICES (23)

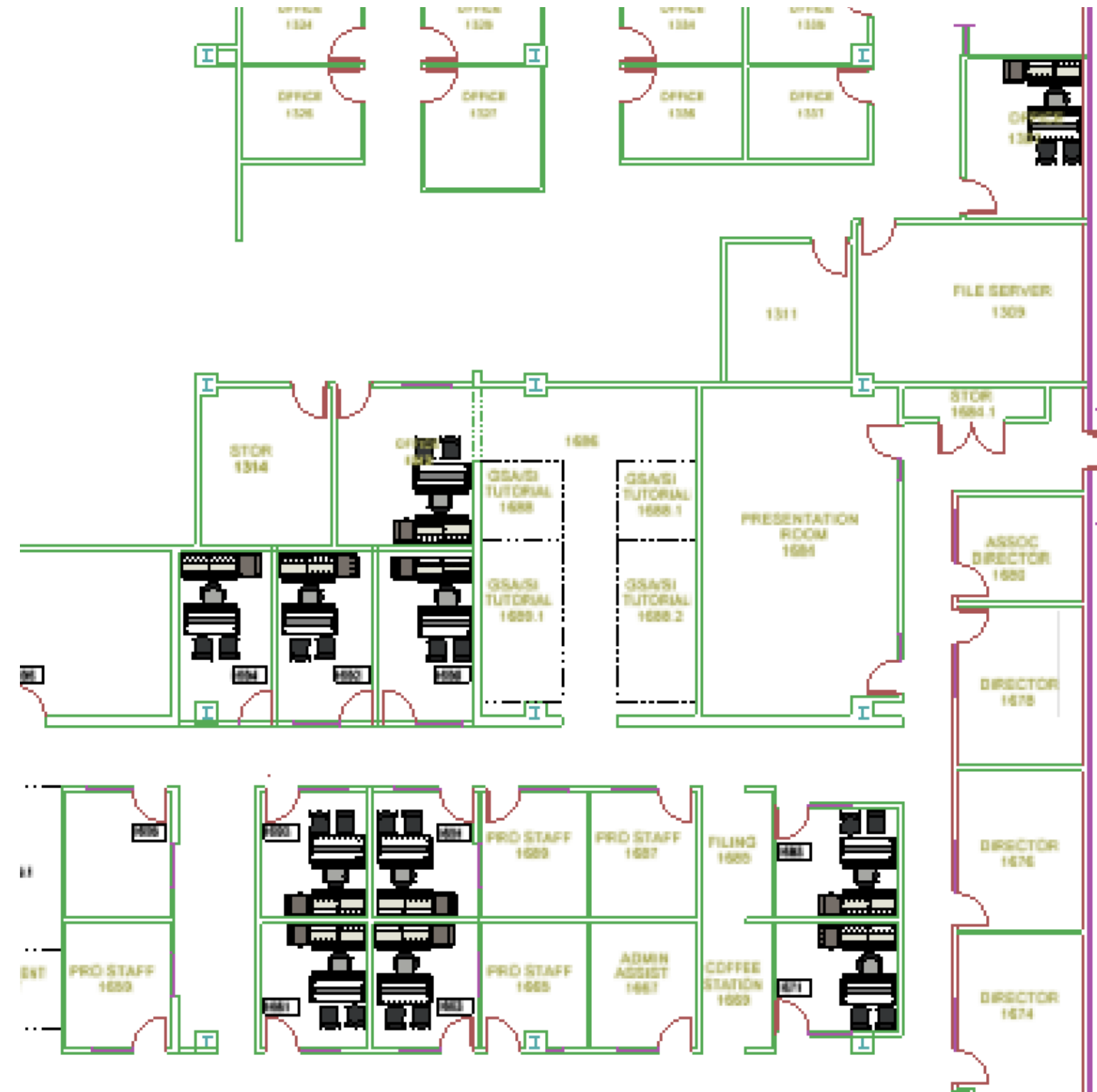
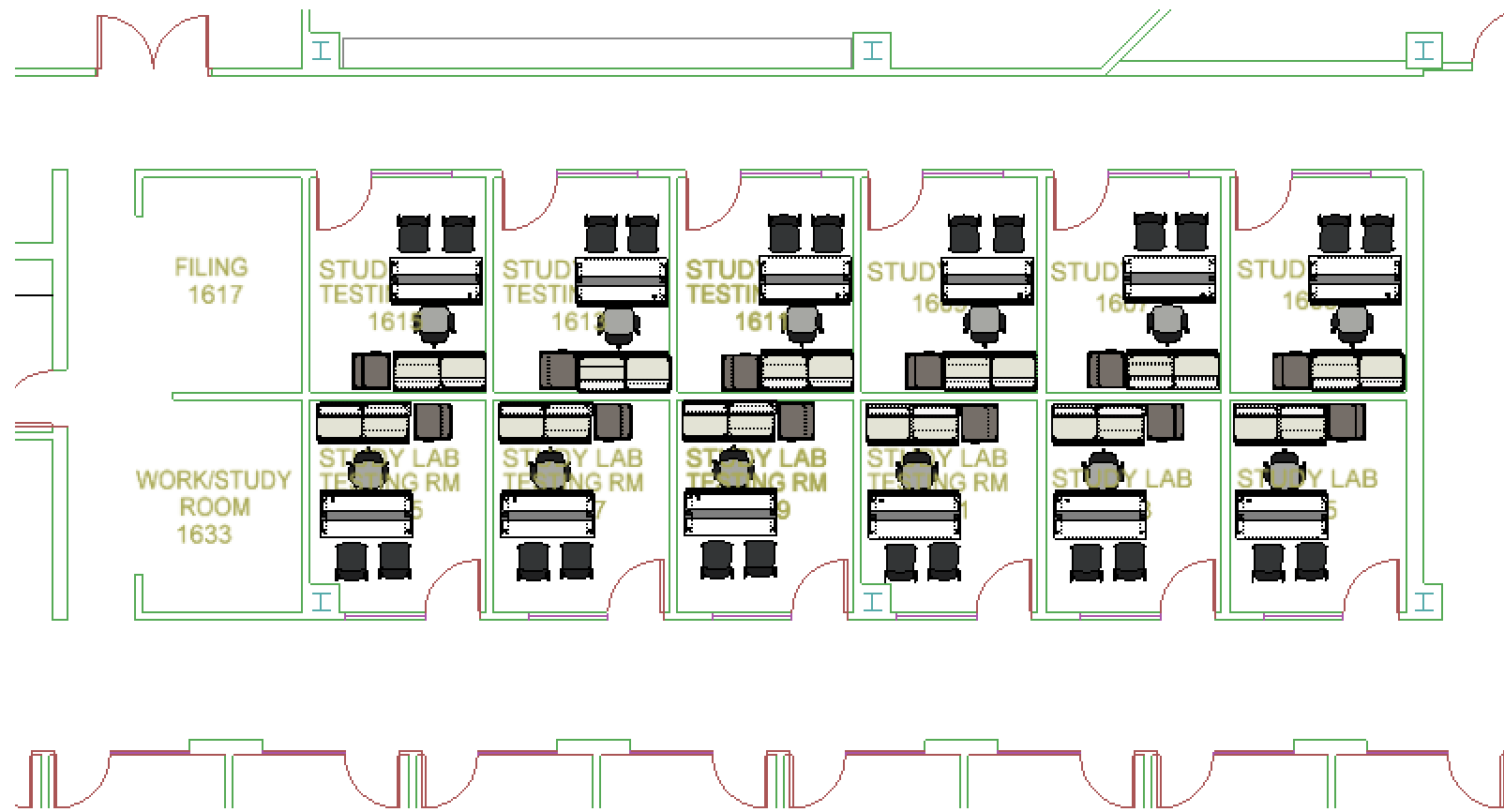

PVT-1 (23) OFFICES

PVT-1 Private Office

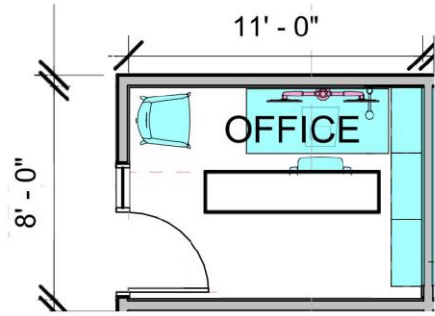

DIMENSIONS: 6'8" x 7'6"

PRODUCT SPECIFICATION

Manufacturer: Allsteel or Similar

Product: Approach or similar

Details:

Storage: Desk to be height adjustable. 2 lateral files and one Tower. Use of Approach Shelves on wall above lateral files. All Laminate.

Tackboard: Felt, full length of overheads.

Worksurface: Woodgrain laminate tops, w/matching edge.

Finishes: Mid Grade, TBD by Stucky Vitale project team

Paint: TBD by Stucky Vitale project team

30 X 60 HEIGHT ADJ TABLE W/MODESTY PANEL

24 X 60 CREDENZA W/BOOKCASE & LATERAL FILE
60" X 8" FLOATING SHELVES (2 PER OFFICE)

WARDROBE STORAGE W/FILE-FILE PEDESTAL,
SHELVES & WARDROBE

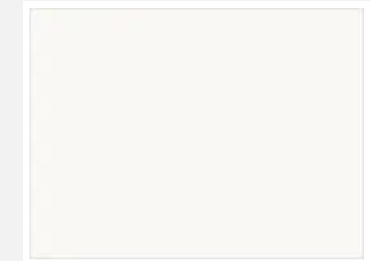
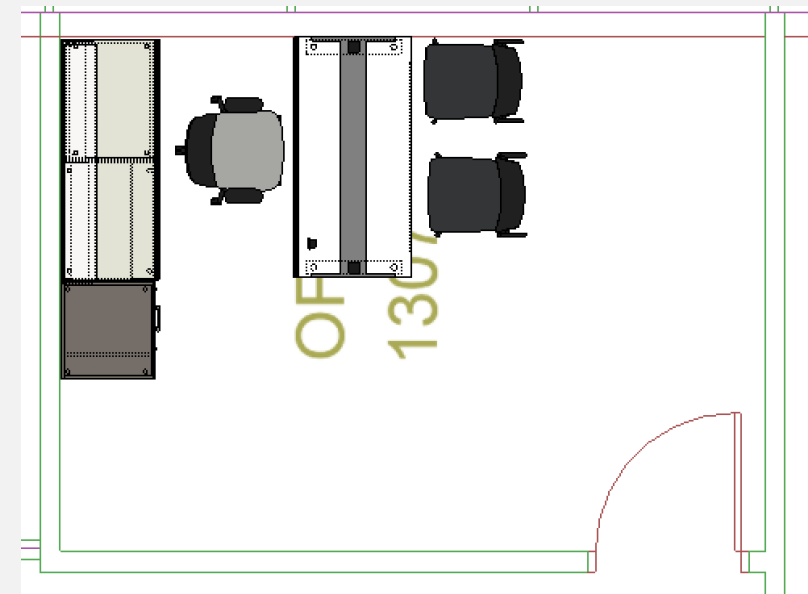

Frosty White (488)

WORKSURFACES & SHELVES:
FROSTY WHITE

STORAGE & MODESTY:
KONA



Kona (KN)

CH-1 PRIVATE OFFICE TASK CHAIRS

Description	Dimensions (Inches)							
	<i>Overall</i>			<i>Seat</i>			<i>Arm</i>	<i>Distance</i>
	<i>H</i>	<i>W</i>	<i>D</i>	<i>H</i>	<i>W</i>	<i>D</i>	<i>H</i>	<i>Between Arms</i>
Armless	39 ⁷ / ₈ –44 ³ / ₄	27	25 ¹ / ₂ –27 ³ / ₄	16 ¹ / ₂ –21 ¹ / ₈	19	17–19		
With HA arms	39 ⁷ / ₈ –44 ³ / ₄	27	25 ¹ / ₂ –27 ³ / ₄	16 ¹ / ₂ –21 ¹ / ₈	19	17–19	23 ³ / ₄ –31 ¹ / ₂	19 ¹ / ₂
With 4D arms	39 ⁷ / ₈ –44 ³ / ₄	27	25 ¹ / ₂ –27 ³ / ₄	16 ¹ / ₂ –21 ¹ / ₈	19	17–19	23 ⁷ / ₈ –32	17 ¹ / ₄ –19 ³ / ₄
With conference arms	39 ⁷ / ₈ –44 ³ / ₄	27	25 ¹ / ₂ –27 ³ / ₄	16 ¹ / ₂ –21 ¹ / ₈	19	17–19	25–29 ³ / ₄	19 ³ / ₄



Black (BL)

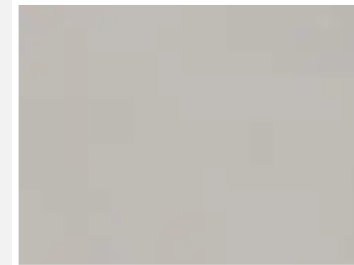

Artesian (11903)

CH-2 – PRIVATE OFFICE SIDE CHAIRS

Description	Dimensions (Inches)							
	<i>Overall</i>			<i>Seat</i>			<i>Arm</i>	
	<i>H</i>	<i>W</i>	<i>D</i>	<i>H</i>	<i>W</i>	<i>D</i>	<i>H</i>	<i>Distance between</i>
All models	33	21	22 ³ / ₄	17	19 ¹ / ₂	20	24 ³ / ₄	18

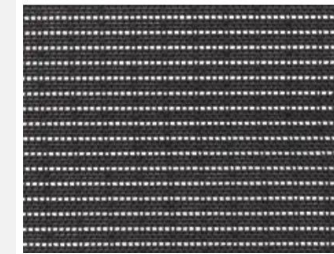

Standard Horizontal
Black



Black (11900)

TESTING AREA CHAIRS

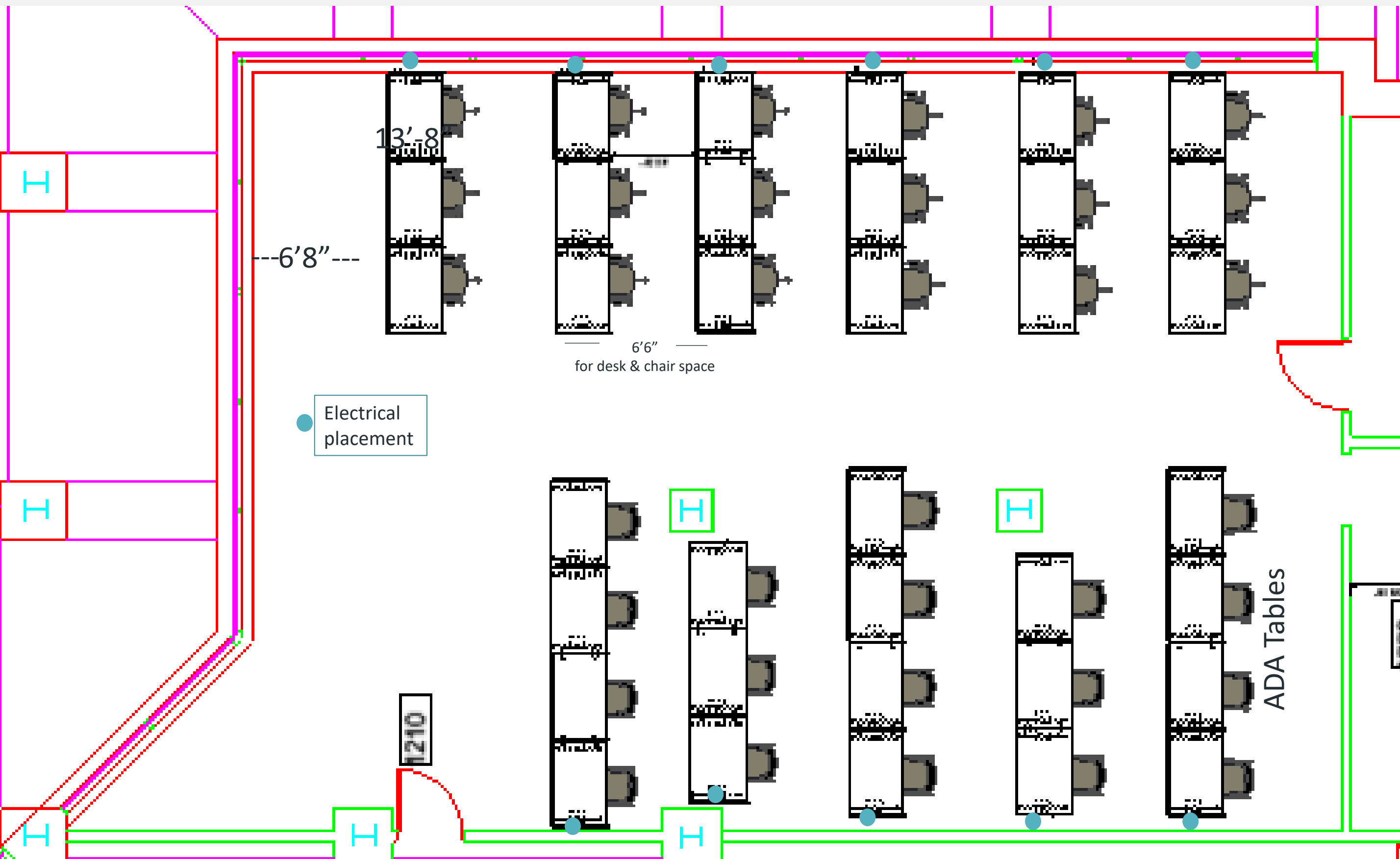

TESTING AREA CHAIRS

- (15) Task Chairs
- (18) Sled based Chairs
- (4) ADA height tables

Screen Felt: Ash

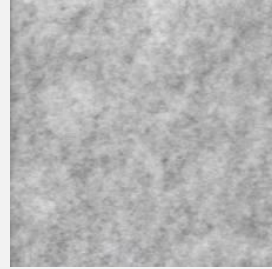

30D X 48W" Stationary tables with screens
Screens have one middle piece between two tables

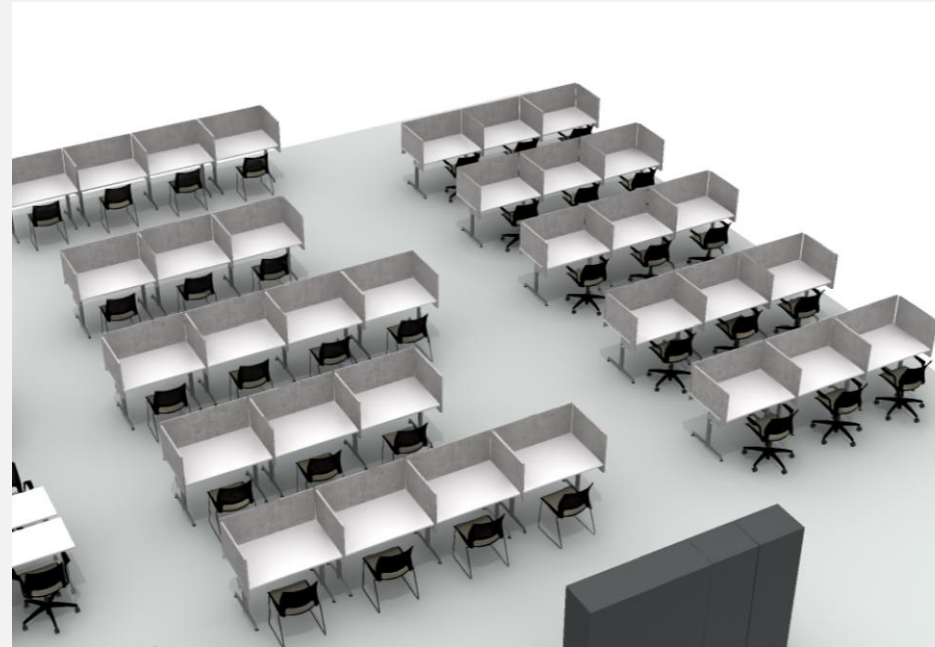

VINYL SEAT:
ELEMENT LEAD

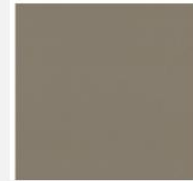

Black (BL)

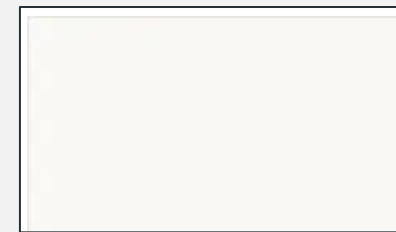
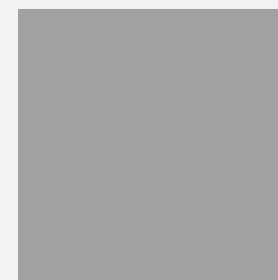

TABLE TOP: WHITE
BASE: SILVER



Multi-circuit power system



Includes scallops at the top of the modesty for cable management



Ganging Cover connects tables and covers cables

STYLE:	Upholstered Seat with Plastic Back
FRAME FINISH:	Black
SHELL COLOR:	Black
CAL 133:	No CAL 133
TEXTILE:	Grade 2
Upholstered Seat:	Fixed
Upholstered Seat:	Basic
BASE COLOR:	Black Nylon
CASTERS:	Carpet Casters
Upholstered Seat:	Back Attached to Seat, Base Separate

WORKSHOP TRAINING

(34) Task Chairs

24"D X 72"WIDE X 30"
HIGH FLIP TOP TABLE

TABLETOP:
WHITE ASH



TABLE BASE: SILVER

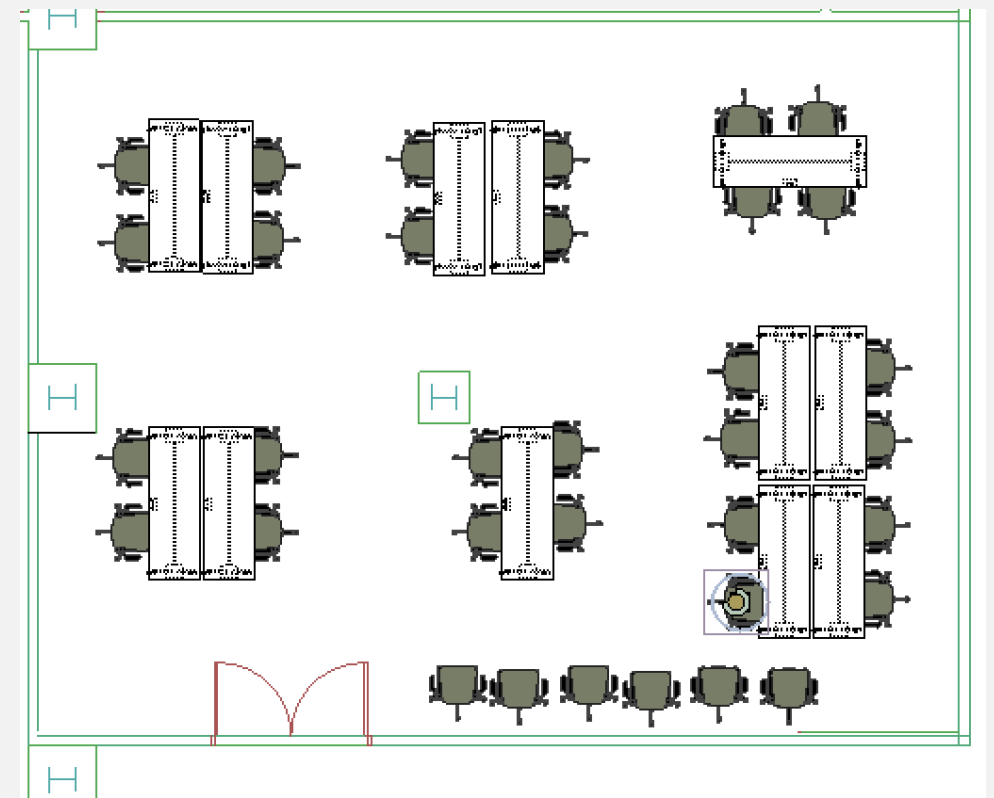

All chairs changed to swivel per Ranjani



Seat Vinyl

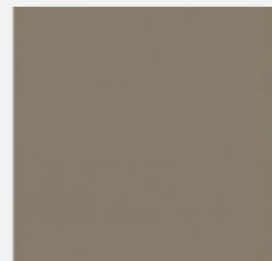

Black Frame



INTERVIEW ROOMS

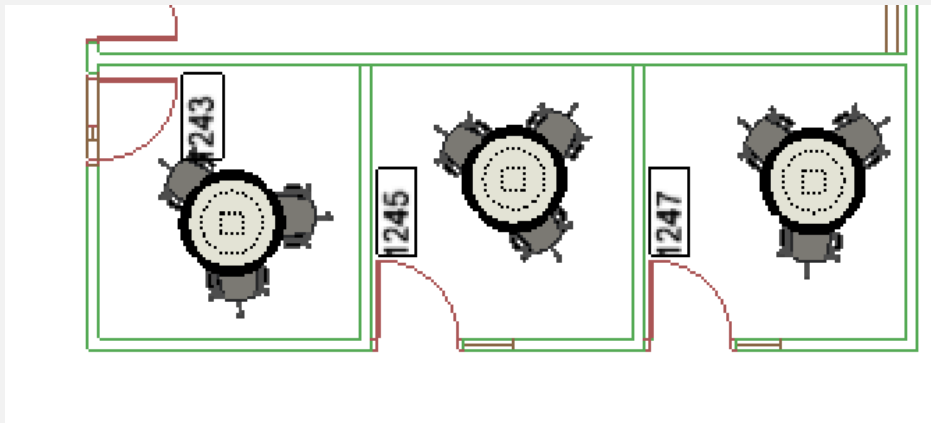

VINYL SEAT:
ELEMENT LEAD

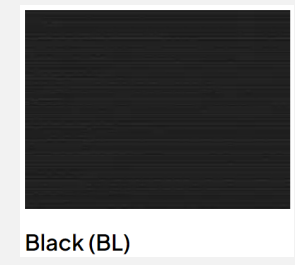
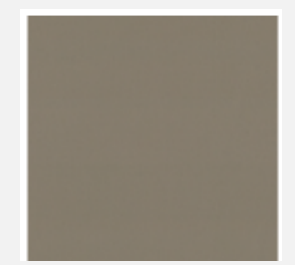

42" WIDE ROUND TABLE
WITH DISC BASE



TABLETOP:
WHITE ASH



WHITE ASH (WA)
Matte Finish

TABLE BASE: SILVER

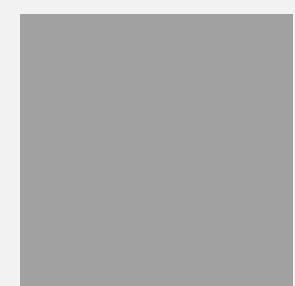

STYLE:	Upholstered Seat with Plastic Back
FRAME FINISH:	Black
SHELL COLOR:	Black
CAL 133:	No CAL 133
TEXTILE:	Grade 2
Upholstered Seat:	Fixed
Upholstered Seat:	Basic
BASE COLOR:	Black Nylon
CASTERS:	Carpet Casters
Upholstered Seat:	Back Attached to Seat, Base Separate

SIMULATION LOUNGE AREA

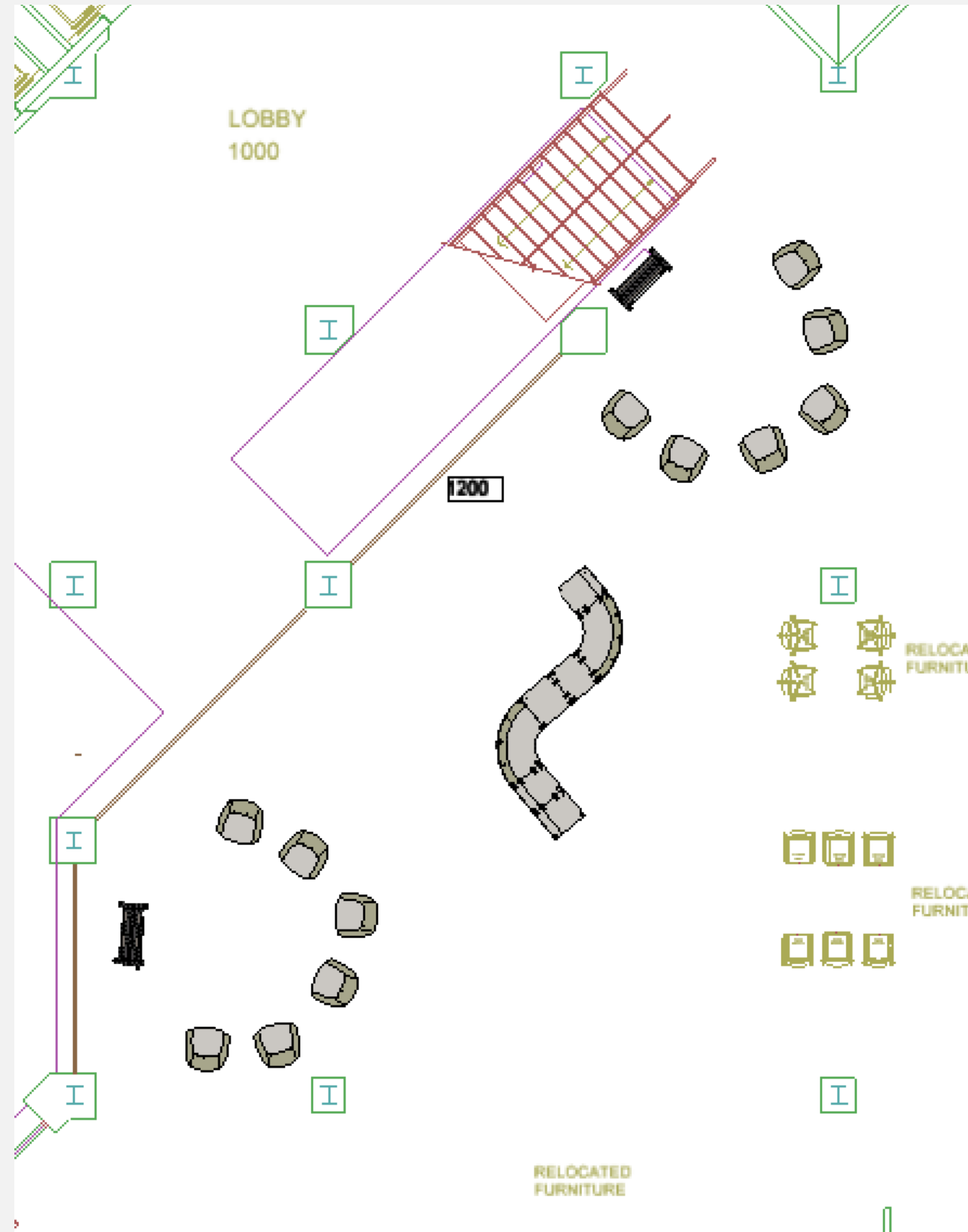

SIMULATION LOUNGE AREA



SEATING

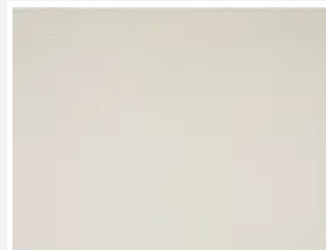

Buckskin (22145)

VINYL SEAT:
SEDONA BUCKSKIN
VINYL BACK & ARMS:
DORSET AVOCADO



Avocado (20502)



Description	Dimensions (Inches)						
	Overall			Seat			Arm
	H	W	D	H	W	D	H
All models	33	30	30	17	20	20	22



TV UNIT



Kona (KN)



TRIM PAINT:
CHARCOAL

D	W	H
Markerboard on One Side		
20 ¹ / ₈ "	42 ³ / ₄ "	67 ³ / ₈ "

One-sided markerboard units are intended for use with a TV mounted to the non-markerboard side. A wire management channel is included through the center of the hinged door cabinet.

Media cart accepts TV up to 42" (measured diagonally) and a combined weight of monitor and mount up to 70 lbs. Mount must be rigidly attached; cannot be articulating mount.

SIMULATION LOUNGE AREA

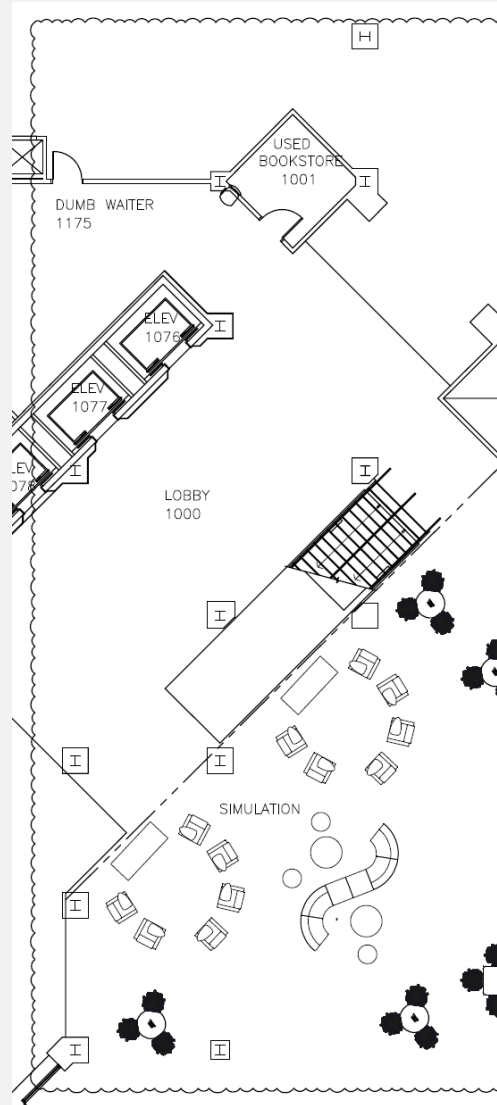

Sectional Lounge Finishes



Avocado (20502)



Buckskin (22145)

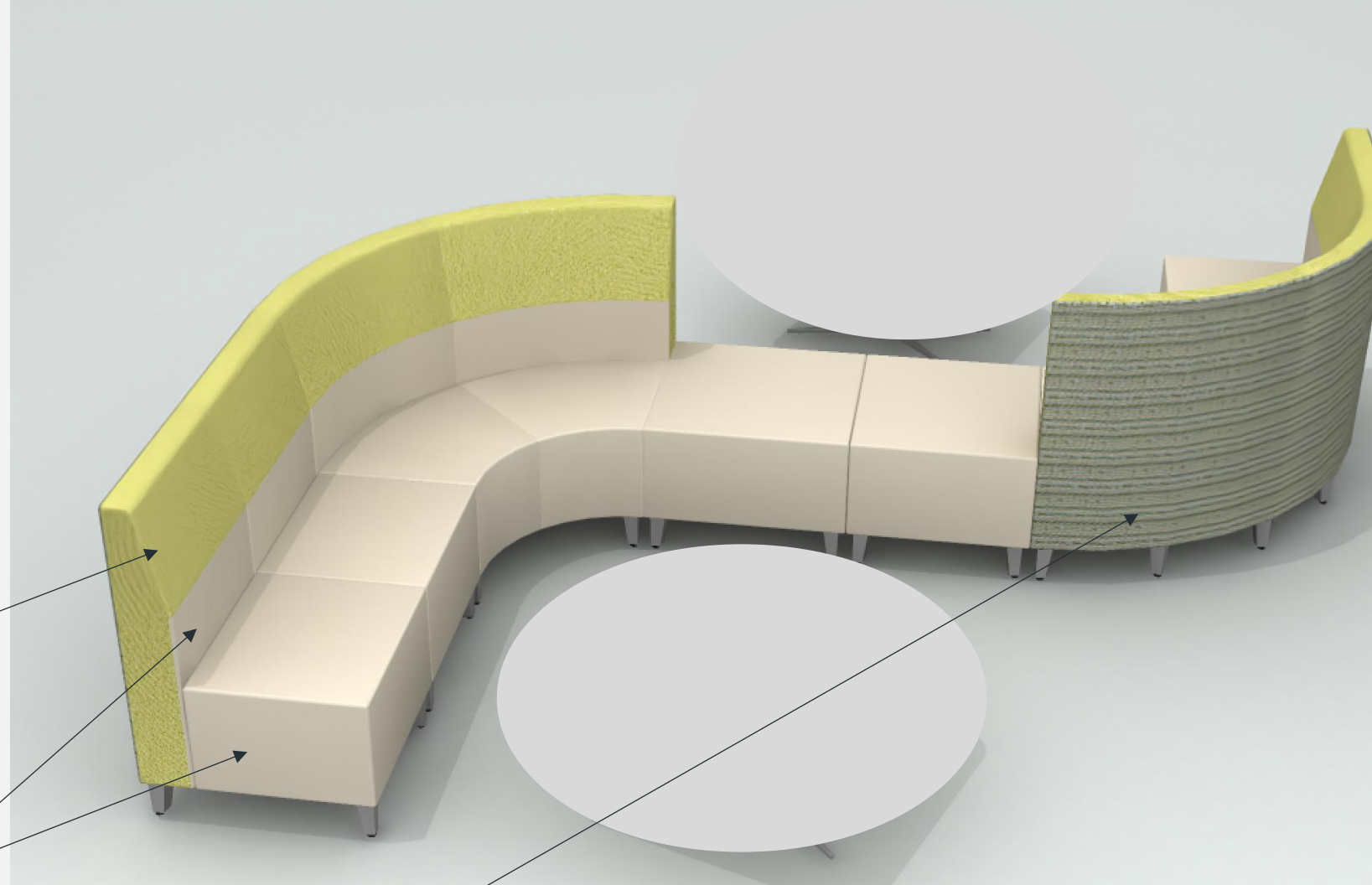

Fringe lounge sectional – approx. 16' long

Dimensions based on single lounge pieces

DIMENSIONS

Width	28	Seat Height	18½
Depth	27	Seat Depth	20½
Height	40¼	Seat Width	24

36" Soft square table

CONFERENCE ROOM



48" WIDE X 216" LONG X 30" HIGH TABLE W/4 BASES

STORAGE CREDENZA
60L" X 24"D X 30H



MILLENNIUM OAK (MO)
Textured Finish

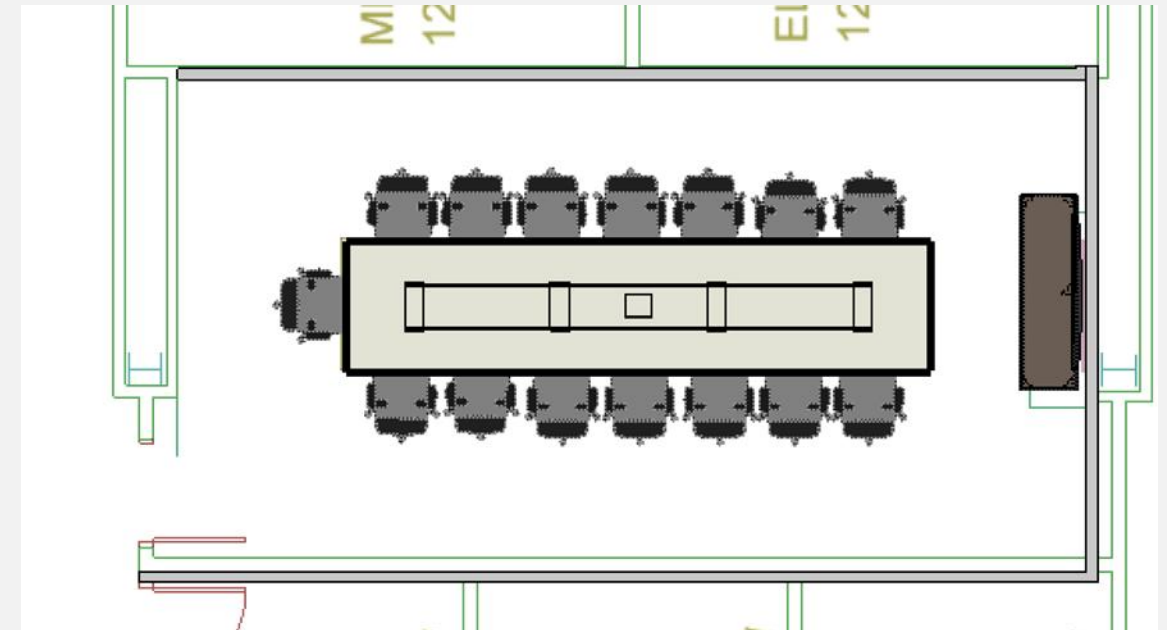

Description	Dimensions (Inches)					
	Overall			Seat		
	H	W	D	H	W	D
Task chair	39 1/4-43 1/4	26 1/4	23	18 1/2-22 1/2	20 3/4	18 1/8



3 ELECTRICAL UNITS

Product Description
In surface dual-sided lift lid power unit

Features

- 4 ports (standard outlets)
- 2 port (A + C)
- 2 ports (1 HDMI/1 CAT6)

Power Cord: 9ft



Black (BL)



Black (11900)